

FOR SALE

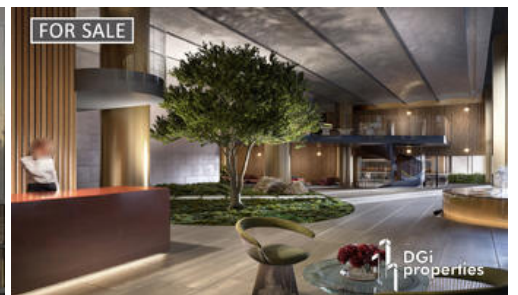

South Melbourne



ICONIC MELBOURNE

\$25,000 HOME BUILDER GRANT QUALIFIED!!!

BUY NOW, SETTLE IN 2022.

EXCEPTIONAL DEVELOPMENT DELIVERED BY RENOWNED PROPERTY DEVELOPER.

- Re-defining inner city living in the expanding CBD South precinct.
- A prime park front location between the City and Port Phillip Bay and sitting adjacent to the highly sought after suburbs of Albert Park, Middle Park and South Melbourne, only 2 km from Melbourne's CBD.
- Residents will enjoy direct and effortless light rail connectivity to the entire CBD, Crown Entertainment Precinct and the renowned arts and theatre precinct. Uninterrupted water views guaranteed to remain due to its locality and planning footprint, this unique development will unify and enrich the lives of its residents and surrounding community.
- With resident amenity focussing on natural surrounds, wellbeing, fitness, entertaining and technology, containing double the amenity of any project of its type. Development contains a world-class hotel within the precinct.

2 2

Price ICONIC MELBOURNE
Property Type residential
Property ID 264

Agent Details

David Gargaro - 0413 202 259
 Tony Gargaro - 0411 222 766

Office Details

Port Melbourne
 152 Rouse Street Port Melbourne VIC
 3207 Australia
 03 9690 9999



The above information provided has been furnished to us by the vendor/s. We have not verified whether or not that information is accurate and do not have any belief in one way or the other in its accuracy. We do not accept any responsibility to any person for its accuracy and do no more than pass it on. All interested parties should make and rely upon their own inquiries in order to determine whether or not this information is in fact accurate.